

a77-277

a60-35

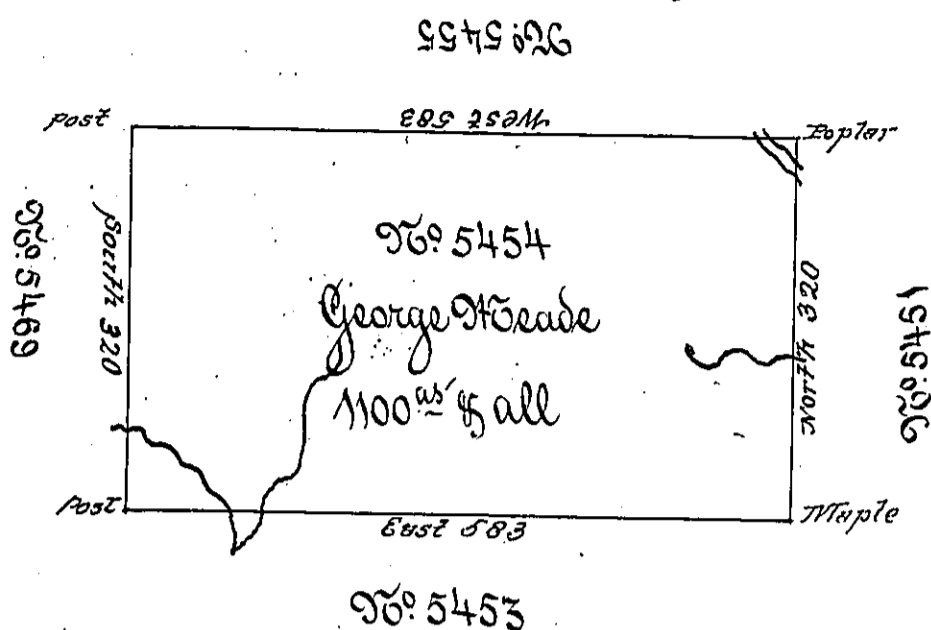

a77-250

a77-263

Situate on the waters of Simemahoning Creek in North County containing 1100 acres and the usual allowance for roads. Surveyed May 8th 1794 for George Wade in pursuance of a Warrant 96° 5454 dated 5th * May 1794

* day 3rd March 1794

Daniel Bradhead Esq: S. G.

John Canan
D.S.

IN TESTIMONY that the above is a copy of the original remaining on file in the Department of Internal Affairs of Pennsylvania, made conformably to an Act of Assembly approved the 16th day of February, 1833, I have hereunto set my Hand and caused the Seal of said Department to be affixed at Harrisburg, this first day of October 1901.

James W. Latta
Secretary of Internal Affairs.